

## **CABINET MEMBER FOR ENVIRONMENT – 17 SEPTEMBER 2020**

### **BANBURY– A361 BLOXHAM ROAD SOUTH OF BANBURY - PROPOSED EXTENSION OF 30 MPH SPEED LIMIT AND PROHIBITION OF MOTOR VEHICLES ON LENGTH SUPERSEDED BY REVISED ROAD LAYOUT**

**Report by Interim Director of Community Operations**

#### **Recommendation**

1. The Cabinet Member for Environment is RECOMMENDED to approve the proposed extension of the 30mph speed limit on the A361 Bloxham Road and the introduction of a prohibition of motor vehicles restriction on part of the length of the Bloxham Road superseded by a revised road layout as advertised.

#### **Executive summary**

2. Speed limits and access restrictions are reviewed when there are changes to the road layout or usage as a result of development and when requested by the local member or local councils due to concerns over road safety.

#### **Introduction**

3. This report presents responses received to a statutory consultation to extend the 30mph speed limit on the A361 Bloxham Road (in place of the existing 40mph speed limit) and introduce a prohibition of motor vehicles restriction on part of the length of the Bloxham Road which is being superseded by a revised layout as part of the construction of a new roundabout as part of approved residential development.

#### **Background**

4. The above proposals as shown at Annex 1 have been put forward with the approved residential development.

#### **Consultation**

5. Formal consultation on the proposal was carried out between 25 June and 24 July 2020. A public notice was placed in the Banbury Guardian newspaper and sent to statutory consultees, including Thames Valley Police, the Fire & Rescue Service, Ambulance Service, Bloxham Parish Council, Cherwell District Council and local County Councillor.

## CMDE7

6. Eight responses were received. These are summarised in the table below:

Proposal	Object	Support	Neither
A361 Bloxham Road Vehicle Prohibition	2	3	3
A361 Bloxham Road 30mph Speed Limit	2	4	2

7. These are recorded at Annex 2. Copies of the full responses are available for inspection by County Councillors.

### **Response to objections and other comments**

8. Thames Valley Police did not object to either proposal.
9. Bloxham Parish Council did not object to the proposed vehicle prohibition but requested that the speed limit on the A361 not be reduced from 50mph to 30mph but from 50mph to 40mph, until the limit reduces to 30mph at the entry to Bloxham. It is confirmed that the proposed 30mph limit extends southwards from Banbury only to the location shown on the plan; the 40mph speed limit then continues to just south of the A361 Wykham Lane crossroads, and the existing 50mph speed limit then applies to the 30mph speed limit at Bloxham.
10. Cherwell District Council did not object to either proposal.
11. Tudor Hall School supported both proposals, noting that they wished to be consulted about detailed plans resulting from the planned new road layout to re-instate the remaining part of the verge on the east side of the A361 and will put in an application for a school sign on the remaining verge.
12. An objection was received from a member of the public to the proposed vehicle prohibition on the grounds of a lack of clarity about the way traffic disruption will be handled during a building programme which is fundamentally unnecessary and economically non-viable in the new emerging economic circumstances. Although these are noted, they are considered not to be material in respect of the justification for the proposals.
13. An objection was received from a member of the public, not a resident of Oxfordshire, to both the proposed vehicle prohibition and the speed limit reduction. No grounds for the objection to the former were given and the objection to the speed limit reduction appeared to be generic and did not reference any local considerations.
14. An expression of support was received from a resident adjacent to the proposed vehicle access restriction to both proposals, noting that they will substantially mitigate the blight caused by traffic adjacent to their property caused by speeding and dangerous overtaking manoeuvres that occur on a daily basis, together with the associated noise and pollution. The only concern is that the (private) access road should be appropriately signed to ensure that only vehicles who are accessing Crouch Cottages (save for emergency vehicles) are permitted to enter so that it does not become an

unofficial lay-by, car park, rest area or caravan park. The above concern is noted and the proposed signing will be reviewed to ensure that it is correct and minimises the risk of the above happening.

### **How the Project supports LTP4 Objectives**

15. The proposals would help facilitate the safe movement of traffic.

### **Financial and Staff Implications (including Revenue)**

16. Funding for the proposed speed limit has been provided by the developers of adjacent land.

### **Equalities Implications**

17. No equalities implications have been identified in respect of the proposals.

JASON RUSSELL  
Interim Director of Community Operations

Background papers:        Consultation plan  
                                      Consultation responses

Contact Officers:         Hugh Potter 07766 998704  
                                     Adam Barrett 07919 175889

September 2020

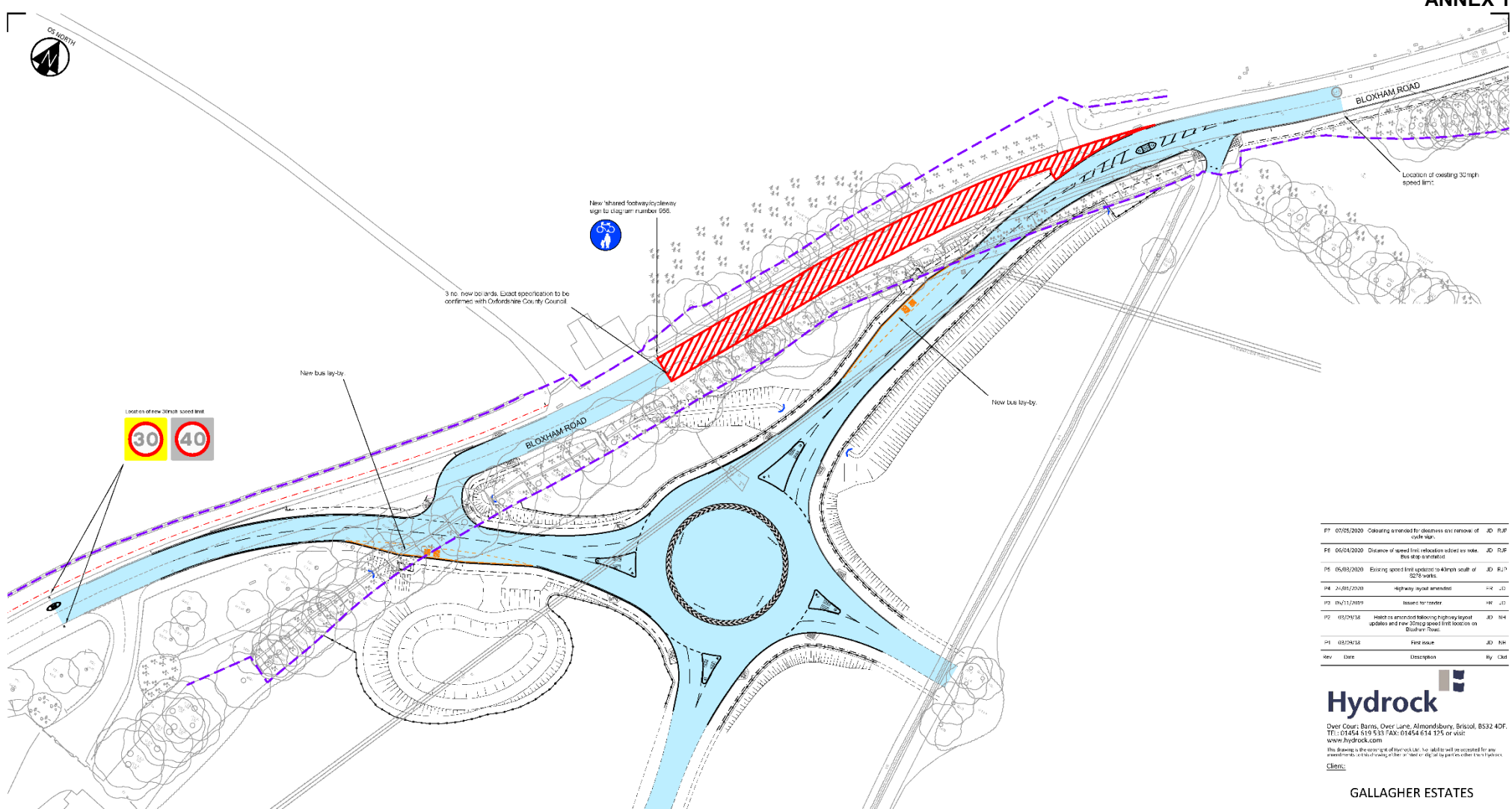

PI	07/05/2020	Colouring amended for cleanliness and removal of cycle sign.	JD	RJP
PE	06/04/2020	Distance of speed limit relocation advised as note. Bus stop repositioned.	JD	RJP
PF	06/08/2020	Existing speed limit updated to 40mph south of S278 works.	JD	ELN
PH	24/01/2020	Highway layout amended.	NH	JD
PI	06/11/2019	Issues for tender.	NH	JD
PI	05/09/18	Issue to ensure that following highway layout updates and new 30mph speed limit location on Bloxham Road.	JD	NH
PI	03/07/18	First issue.	JD	NH
Rev	Date	Description	By	Clk

**Hydrock**  
 Over Court Barns, Over Lane, Almondsbury, Bristol, BS32 4DF.  
 Tel: 01454 519 533 FAX: 01454 614 125 or visit [www.hydrock.com](http://www.hydrock.com)  
 This drawing is the property of Hydrock Ltd. It shall not be used for any other project without the prior written consent of Hydrock Ltd.  
 Client:

GALLAGHER ESTATES

**Legend:**

- Extent of Existing Oxfordshire County Council Highway ownership.
- Section of existing carriageway to be downgraded to pedestrian / cycle route and prohibition of any motor vehicles.
- Extents of new 30mph speed limit (existing 40mph speed limit on A261 to be revoked) by virtue of street lighting. To be read in conjunction with Oxfordshire County Council A261 Proposed Speed Limits drawing.

N/B 30mph speed limit extended by approximately 300m on Bloxham Road

Project:  
**WYKHAM PARK FARM  
 BANBURY**

Project Number: **C-04841-C**

Drawing Title:  
**S278 WORKS  
 ROUNDABOUT  
 TRO PLAN**

Drawn:	Checked:	Scale @ A1:	Drawn Date:	First Issue:
JD	NH	1:500	03/09/2018	03/09/2018
Status:	D2	Purpose of Issue:	TENDER	
Drawing No:	WPF-HYD-XX-XX-DR-D-0161	Revision:	P7	

RESPONDENT	SUMMARISED COMMENTS
(1) Traffic Management Officer, (Thames Valley Police)	<b>No objection</b> – The new development will move the village urban character south and the revised plan for the 30mph limit appears appropriate.
(2) Bloxham Parish Council	<p>A361 Bloxham Road Vehicle Prohibition – <b>No objection</b>  A361 Bloxham Road 30mph Speed Limit - <b>Object</b></p> <p>The speed limit on the A361 not be reduced from 50mph to 30mph but from 50mph to 40mph, until the limit reduces to 30mph anyway as the A361 enters Bloxham.</p>
(3) Planning Department, (Cherwell District Council)	<b>No objection</b> – In relation to the works to extend the speed limit on the A361 and Bloxham Grove Road the Planning Department note that these are required in connection with the proposed new school. It is noted that a number of additional highway works are required to be undertaken for the new school which do not form part of the current consultation, but it is assumed that these changes will be consulted upon separately.
(4) Local School (Banbury)	<p>A361 Bloxham Road Vehicle Prohibition – <b>Support</b>  A361 Bloxham Road 30mph Speed Limit - <b>Support</b></p> <p>Tudor Hall School notes and supports the plan to close a section of the existing A361 carriageway when the new roundabout to the Wykham Farm Site is opened. The School notes that a section of the existing grass verge, which has been maintained by the School for over twenty years, will become a carriageway. The School will wish to be consulted about detailed plans to re-instate the remaining part of the verge and will put in an application for a school sign on the remaining verge.</p>

CMDE7

<p>(5) Online Response (Banbury)</p>	<p>A361 Bloxham Road Vehicle Prohibition – <b>Object</b> A361 Bloxham Road 30mph Speed Limit - <b>Support</b></p> <p>Lack of clarity about the way traffic disruption will be handled during a building programme which is fundamentally unnecessary and economically non-viable in the new emerging economic circumstances.</p>
<p>(6) Individual (Manchester)</p>	<p>A361 Bloxham Road Vehicle Prohibition – <b>Object</b> A361 Bloxham Road 30mph Speed Limit - <b>Object</b></p> <p>Councils need to stop reducing speed limits every time an accident happens. I am a driving instructor and I'm all for road safety, but reducing limits isn't the answer.</p>
<p>(7) Local Resident (Banbury)</p>	<p>A361 Bloxham Road Vehicle Prohibition – <b>Support</b> A361 Bloxham Road 30mph Speed Limit - <b>Support</b></p> <p>The proposal will substantially mitigate the blight caused by traffic adjacent to our property caused by speeding and dangerous overtaking manoeuvres that occur on a daily basis, together with the associated noise and pollution. The only concern is that the (private) access road should be appropriately signed to ensure that only vehicles who are accessing Crouch Cottages (save for emergency vehicles) are permitted to enter so that it does not become an unofficial lay-by, car park, rest area, or caravan park.</p>
<p>(8) Local Resident (Banbury)</p>	<p>A361 Bloxham Road 30mph Speed Limit - <b>Support</b> Bloxham Grove Road 30mph Speed Limit - <b>Support</b></p> <p>The proposal will substantially mitigate the blight caused by traffic adjacent to our property caused by speeding and dangerous overtaking manoeuvres that occur on a daily basis, together with the associated noise and pollution. The only concern is that the (private) access road should be appropriately signed to ensure that only vehicles who are accessing Crouch Cottages (save for emergency vehicles) are permitted to enter so that it does not become an unofficial lay-by, car park, rest area, or caravan park.</p>

CMDE7